

# SENSOR BAR INSTALLATION

Micro switch dry contacts are rated  
3Amp/125VAC or 1Amp 30VDC for  
safe operation.  
Do not exceed this rating.

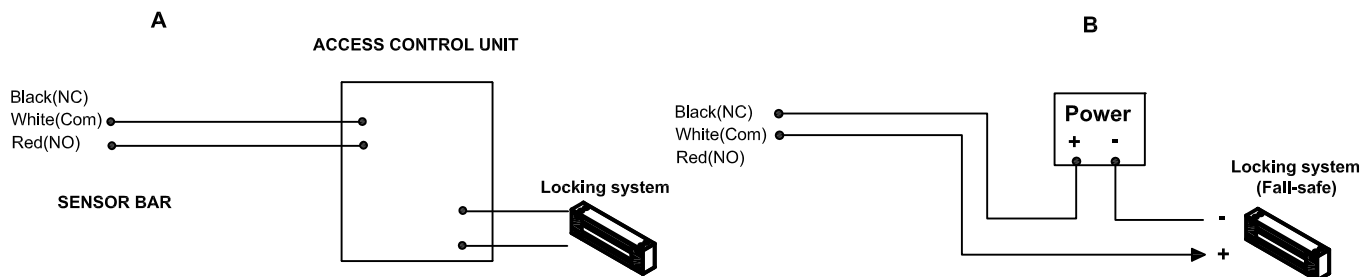
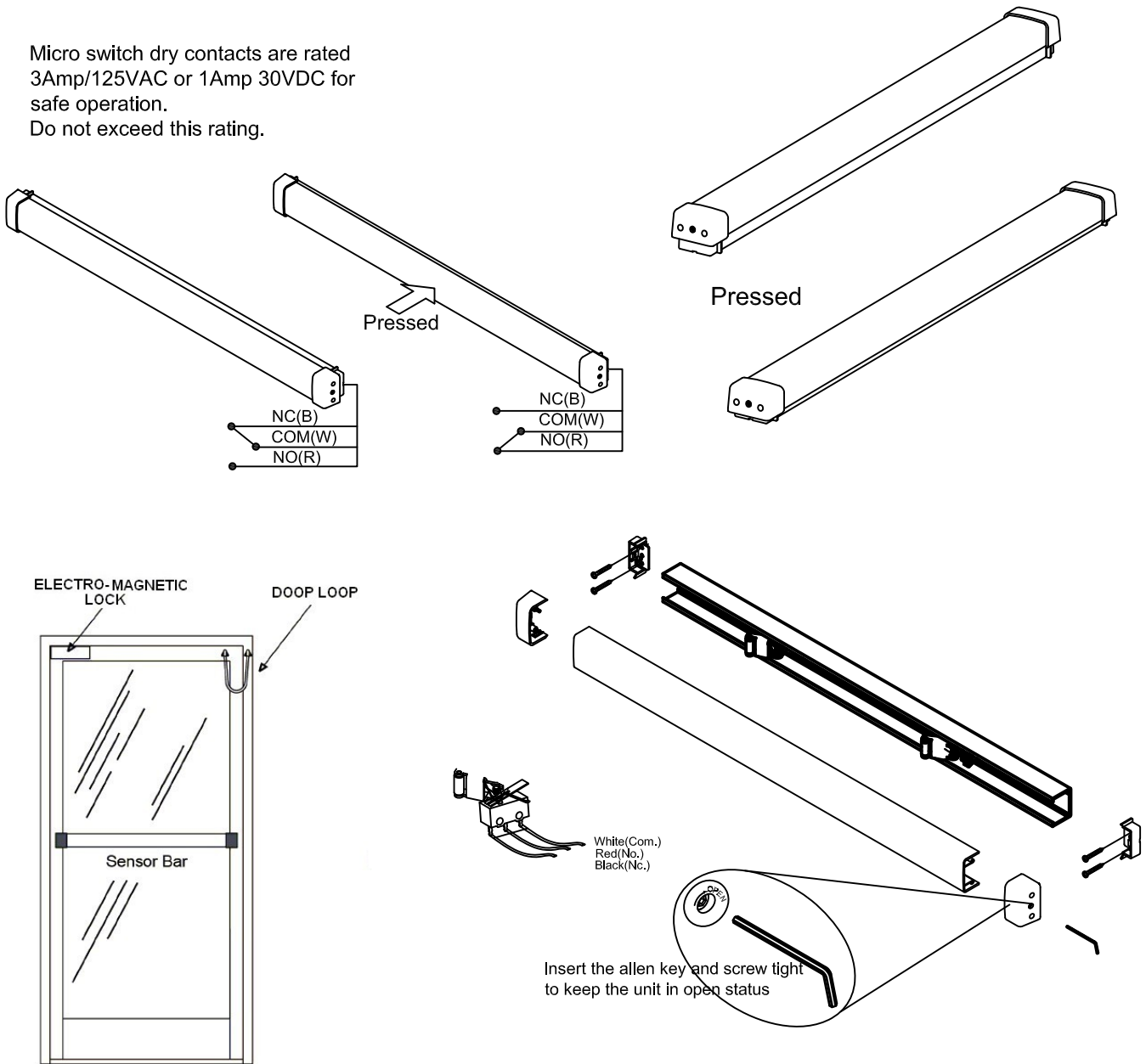

**A. Applied with Access Control system.**  
Press the Sensor bar to activate the access control unit to open.

**B. Applied to fail safe locking system, to activate it.**  
When applied to non-fail safe IOcKing system,  
connect to red wire (NO).